

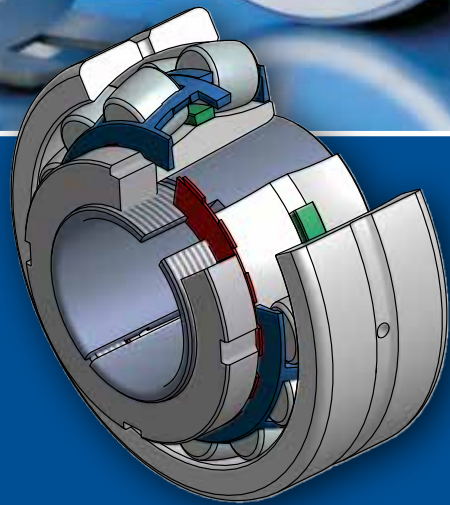

PRÍSLUŠENSTVO



PRÍSLUŠENSTVO

Pod pojmom príslušenstvo sa rozumejú normalizované strojové súčasti, ktoré slúžia na upevnenie valivých ložísk na hriadeľ, alebo v diere telesa.

Ide o upínacie a sťahovacie púzdra, kruhové upínacie a sťahovacie matice, poistné podložky a poistné krúžky pre ložiská s drážkou na vonkajšom krúžku.



UPÍNACIE A SŤAHOVACIE PÚZDRA

Upínacie a sťahovacie púzdra sa používajú na zaistenie ložísk s kužeľovou dierou na valcovom čape. Uľahčujú montáž a demontáž a často zjednodušia aj konštrukciu uloženia. Upínacie púzdra sú rozšírenejšie, ich montáž je jednoduchšia ako v prípade sťahovacích púzdiel. Ložiská so sťahovacím púzdrom sa musia opierať o pevnú súčasť, napr. osadenie. Sťahovacie púzdra sa musia zaistiť na hriadeľ po zalisovaní do diery ložiska pomocou koncovkej matice, alebo koncovkej dosky.

UPÍNACIE PÚZDRA

Upínacie púzdra sa dodávajú kompletne s koncovou maticou a poistnou podložkou. Púzdra sú rozrezané a kužeľovitost' vonkajšej časti je 1:12. Rozmery upínacích púzdiel zodpovedajú ISO 113/I. Upínacie púzdra väčších priemerov sa štandardne vyrábajú s kanálkami pre prívod tlakového oleja na strane závitú a drážkou na vonkajšom povrchu – označenie OH...H. Púzdra s drážkou v otvore aj na povrchu majú označenie OH...HB. Púzdra s prívodnými kanálkami na strane opačnej k závitú a drážkou na vonkajšom priemere majú označenie OH, s drážkou na povrchu aj v otvore majú označenie OH...B.



SŤAHOVACIE PÚZDRA

Sťahovacie púzdra sú rozrezané a majú kužeľový vonkajší povrch. Rozmery sťahovacích púzdiel zodpovedajú ISO 2982. Matice pre sťahovanie púzdiel nie sú súčasťou dodávky a musia sa objednávať zvlášť. Sťahovacie púzdra väčších priemerov sa štandardne vyrábajú s kanálkami pre prívod tlakového oleja na strane závitú a drážkami na vonkajšom povrchu a v otvore – označenie AOH.

UPÍNACIE A SŤAHOVACIE KRUHOVÉ MATICE

Kruhové matice sú určené na zaistenie vnútorných krúžkov na upínacích púzdрах, alebo priamo na čape prípadne na montáž a demontáž na sťahovacích púzdрах. Kruhové matice sú opatrené drážkami na vonkajšom priemere na umožnenie manipulácie s nimi. Rozmery koncových matic zodpovedajú norme ISO 2982.



POISTNÉ PODLOŽKY, POISTNÉ VLOŽKY

Poistné podložky sú určené na zaistenie kruhových matic menšieho priemeru zatiaľ čo poistné vložky typu MSL pre väčšie matice. Poistné podložky sa vyrábajú z hlbokoťažného oceľového plechu a ich rozmery zodpovedajú norme ISO 2982. Poistné vložky sú vyrobené takisto z hlbokoťažného plechu a ku kruhovej matici sa pripájajú skrutkou. Skrutka a podložka sú rovnako súčasťou dodávky.

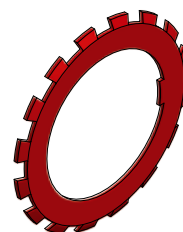

UPÍNACIE PÚZDRA

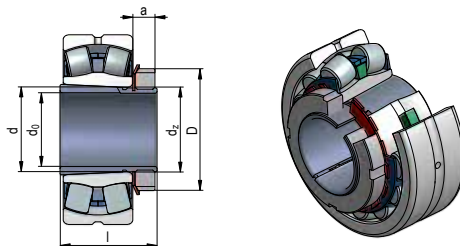

Rozmery mm								Hmotnosť	Označenie púzdra	Príslušné súčasti	
d ₀	d	D	l	a	a ₁	d _z	d _{z1}	kg	vrátane matice a poistenia	Matica	Podložka
12	15	25	19	6	-	M15x1	-	0,024	H202	KM2	MB2
	15	25	22	6	-	M15x1	-	0,026	H302	KM2	MB2
	15	25	25	6	-	M15x1	-	0,032	H2302	KM2	MB2
14	17	28	20	6	-	M17x1	-	0,03	H203	KM3	MB3
	17	28	24	6	-	M17x1	-	0,036	H303	KM3	MB3
	17	28	27	6	-	M17x1	-	0,042	H2303	KM3	MB3
17	20	32	24	7	-	M20x1	-	0,036	H204	KM4	MB4
	20	32	24	7	-	M20x1	-	0,04	H304	KM4	MB4
	20	32	24	7	-	M20x1	-	0,05	H2304	KM4	MB4
20	25	38	26	8	-	M25x1,5	-	0,064	H205	KM5	MB5
	25	38	29	8	-	M25x1,5	-	0,071	H305	KM5	MB5
	25	38	35	8	-	M25x1,5	-	0,085	H2305	KM5	MB5
25	30	45	27	8	-	M30x1,5	-	0,086	H206	KM6	MB6
	30	45	31	8	-	M30x1,5	-	0,095	H306	KM6	MB6
	30	45	38	8	-	M30x1,5	-	0,11	H2306	KM6	MB6
30	35	52	29	9	-	M35x1,5	-	0,12	H207	KM7	MB7
	35	52	35	9	-	M35x1,5	-	0,14	H307	KM7	MB7
	35	52	43	9	-	M35x1,5	-	0,16	H2307	KM7	MB7
35	40	58	31	10	-	M40x1,5	-	0,16	H208	KM8	MB8
	40	58	36	10	-	M40x1,5	-	0,17	H308	KM8	MB8
	40	58	46	10	-	M40x1,5	-	0,22	H2308	KM8	MB8
40	45	65	33	11	-	M45x1,5	-	0,22	H209	KM9	MB9
	45	65	39	11	-	M45x1,5	-	0,23	H309	KM9	MB9
	45	65	50	11	-	M45x1,5	-	0,27	H2309	KM9	MB9
45	50	70	35	12	-	M50x1,5	-	0,24	H210	KM10	MB10
	50	70	42	12	-	M50x1,5	-	0,27	H310	KM10	MB10
	50	70	55	12	-	M50x1,5	-	0,34	H2310	KM10	MB10
50	55	75	37	12	-	M55x2	-	0,28	H211	KM11	MB11
	55	75	45	12	-	M55x2	-	0,32	H311	KM11	MB11
	55	75	59	12	-	M55x2	-	0,39	H2311	KM11	MB11
55	60	80	38	13	-	M60x2	-	0,31	H212	KM12	MB12
	60	80	47	13	-	M60x2	-	0,39	H312	KM12	MB12
	60	80	62	13	-	M60x2	-	0,45	H2312	KM12	MB12
60	65	85	40	14	-	M65x2	-	0,36	H213	KM13	MB13
	65	85	50	14	-	M65x2	-	0,42	H313	KM13	MB13
	65	85	65	14	-	M65x2	-	0,52	H2313	KM13	MB13
60	70	92	41	14	-	M70x2	-	0,59	H214	KM14	MB14
	70	92	52	14	-	M70x2	-	0,67	H314	KM14	MB14
	70	92	41	14	-	M70x2	-	0,88	H2314	KM14	MB14
65	75	98	43	15	-	M75x2	-	0,66	H215	KM15	MB15
	75	98	55	15	-	M75x2	-	0,78	H315	KM15	MB15
	75	98	73	15	-	M75x2	-	1,1	H2315	KM15	MB15
70	80	105	46	17	-	M80x2	-	0,81	H216	KM16	MB16
	80	105	59	17	-	M80x2	-	0,95	H316	KM16	MB16
	80	105	78	17	-	M80x2	-	1,2	H2316	KM16	MB16
75	85	110	50	18	-	M85x2	-	0,94	H217	KM17	MB17
	85	110	63	18	-	M85x2	-	1,1	H317	KM17	MB17
	85	110	82	18	-	M85x2	-	1,35	H2317	KM17	MB17
80	90	120	52	18	-	M90x2	-	1,1	H218	KM18	MB18
	90	120	65	18	-	M90x2	-	1,3	H318	KM18	MB18
	90	120	86	18	-	M90x2	-	1,6	H2318	KM18	MB18

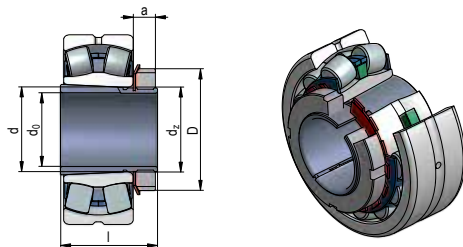

Rozmery mm								Hmotnosť	Označenie púzdra	Príslušné súčasti	
d ₀	d	D	l	a	a ₁	d ₂	d ₂₁	kg	vrátane matice a poistenia	Matica	Podložka
85	95	125	55	19	-	M95x2	-	1,25	H219	KM19	MB19
	95	125	68	19	-	M95x2	-	1,4	H319	KM19	MB19
	95	125	90	19	-	M95x2	-	1,8	H2319	KM19	MB19
90	100	130	58	20	-	M100x2	-	1,4	H220	KM20	MB20
	100	130	71	20	-	M100x2	-	1,6	H320	KM20	MB20
	100	130	97	20	-	M100x2	-	2	H2320	KM20	MB20
	100	130	76	20	-	M100x2	-	1,8	H3120	KM20	MB20
95	105	140	60	20	-	M105x2	-	1,6	H221	KM21	MB21
	105	140	74	20	-	M105x2	-	1,85	H321	KM21	MB21
	105	140	101	20	-	M105x2	-	2,46	H2321	KM21	MB21
100	110	145	63	21	-	M110x2	-	1,8	H222	KM22	MB22
	110	145	77	21	-	M110x2	-	2,05	H322	KM22	MB22
	110	155	105	21	-	M110x2	-	2,75	H2322	KM22	MB22
	110	155	81	21	-	M110x2	-	2,75	H3122	KM22	MB22
110	120	145	72	22	-	M120x2	-	1,8	H3024	KML24	MBL24
	120	155	88	22	-	M120x2	-	2,5	H3124	KM24	MB24
	120	155	112	22	-	M120x2	-	3	H2324	KM24	MB24
115	130	155	80	23	-	M130x2	-	2,8	H3026	KML26	MBL26
	130	165	92	23	-	M130x2	-	3,45	H3126	KM26	MB26
	130	165	121	23	-	M130x2	-	4,46	H2326	KM26	MB26
125	140	165	82	24	-	M140x2	-	3,05	H3028	KML28	MBL28
	140	180	97	24	-	M140x2	-	4,1	H3128	KM28	MB28
	140	180	131	24	-	M140x2	-	5,4	H2328	KM28	MB28
135	150	180	87	26	-	M150x2	-	3,75	H3030	KML30	MBL30
	150	195	111	26	-	M150x2	-	5,27	H3130	KM30	MB30
	150	195	139	26	-	M150x2	-	6,4	H2330	KM30	MB30
140	160	190	93	28	-	M160x3	-	5,1	H3032	KML32	MBL32
	160	190	93	28	-	M160x3	M6	5,1	OH3032H	KML32	MBL32
	160	190	93	28	-	M160x3	M6	5,1	OH3032B	KML32	MBL32
	160	190	93	28	-	M160x3	M6	5,1	OH3032HB	KML32	MBL32
	160	210	119	28	-	M160x3	-	7,25	H3132	KM32	MB32
	160	210	119	28	-	M160x3	M6	7,25	OH3132	KM32	MB32
	160	210	119	28	-	M160x3	M6	7,25	OH3132H	KM32	MB32
	160	210	119	28	-	M160x3	M6	7,25	OH3132B	KM32	MB32
	160	210	119	28	-	M160x3	M6	7,25	OH3132HB	KM32	MB32
	160	210	147	28	-	M160x3	-	8,8	H2332	KM32	MB32
	160	210	147	28	-	M160x3	M6	8,8	OH2332	KM32	MB32
	160	210	147	28	-	M160x3	M6	8,8	OH2332H	KM32	MB32
	160	210	147	28	-	M160x3	M6	8,8	OH2332B	KM32	MB32
	160	210	147	28	-	M160x3	M6	8,8	OH2332HB	KM32	MB32
150	170	200	101	29	-	M170x3	-	5,8	H3034	KML34	MBL34
	170	200	101	29	-	M170x3	M6	5,8	OH3034	KML34	MBL34
	170	200	101	29	-	M170x3	M6	5,8	OH3034H	KML34	MBL34
	170	200	101	29	-	M170x3	M6	5,8	OH3034B	KML34	MBL34
	170	200	101	29	-	M170x3	M6	5,8	OH3034HB	KML34	MBL34
	170	200	122	29	-	M170x3	-	8,1	H3134	KM34	MB34
	170	200	122	29	-	M170x3	M6	8,1	OH3134	KM34	MB34
	170	200	122	29	-	M170x3	M6	8,1	OH3134H	KM34	MB34
	170	200	122	29	-	M170x3	M6	8,1	OH3134B	KM34	MB34
	170	200	122	29	-	M170x3	M6	8,1	OH3134HB	KM34	MB34

UPÍNACIE PÚZDRA

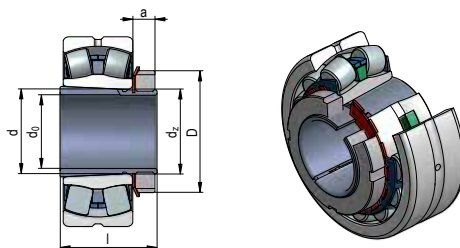

Rozmery mm								Hmotnosť	Označenie púzdra	Príslušné súčasti		
d ₀	d	D	l	a	a ₁	d _z	d _{z1}	kg	vrátane matice a poistenia	Matica	Podložka	
150	170	200	154	29	-	M170x3	-	9,9	H2334	KM34	MB34	
	170	200	154	29	-	M170x3	M6	9,9	OH2334H	KM34	MB34	
	170	200	154	29	-	M170x3	M6	9,9	OH2334B	KM34	MB34	
	170	200	154	29	-	M170x3	M6	9,9	OH2334HB	KM34	MB34	
	180	210	109	30	-	M180x3	-	6,7	H3036	KML36	MBL36	
160	180	210	109	30	-	M180x3	M6	6,7	OH3036H	KML36	MBL36	
	180	210	109	30	-	M180x3	M6	6,7	OH3036B	KML36	MBL36	
	180	210	109	30	-	M180x3	M6	6,7	OH3036HB	KML36	MBL36	
	180	210	109	30	-	M180x3	-	9,15	H3136	KM36	MB36	
	180	210	109	30	-	M180x3	M6	9,15	OH3136H	KM36	MB36	
	180	210	109	30	-	M180x3	M6	9,15	OH3136B	KM36	MB36	
	180	210	109	30	-	M180x3	M6	9,15	OH3136HB	KM36	MB36	
	180	210	109	30	-	M180x3	-	11	H2336	KM36	MB36	
	180	210	109	30	-	M180x3	M6	11	OH2336	KM36	MB36	
	180	210	109	30	-	M180x3	M6	11	OH2336H	KM36	MB36	
	180	210	109	30	-	M180x3	M6	11	OH2336B	KM36	MB36	
	180	210	109	30	-	M180x3	M6	11	OH2336HB	KM36	MB36	
	170	190	220	112	31	-	M190x3	-	7,25	H3038	KML38	MBL38
		190	220	112	31	-	M190x3	M6	7,25	OH3038H	KML38	MBL38
		190	220	112	31	-	M190x3	M6	7,25	OH3038B	KML38	MBL38
190		220	112	31	-	M190x3	M6	7,25	OH3038HB	KML38	MBL38	
190		220	141	31	-	M190x3	-	10,5	H3138	KM38	MB38	
190		220	141	31	-	M190x3	M6	10,5	OH3138H	KM38	MB38	
190		220	141	31	-	M190x3	M6	10,5	OH3138B	KM38	MB38	
190		220	141	31	-	M190x3	M6	10,5	OH3138HB	KM38	MB38	
190		220	169	31	-	M190x3	-	12	H2338	KM38	MB38	
190		220	169	31	-	M190x3	M6	12	OH2338	KM38	MB38	
190		220	169	31	-	M190x3	M6	12	OH2338H	KM38	MB38	
190		220	169	31	-	M190x3	M6	12	OH2338B	KM38	MB38	
190		220	169	31	-	M190x3	M6	12	OH2338HB	KM38	MB38	
180		200	240	120	32	-	M200x3	-	8,9	H3040	KML40	MBL40
		200	240	120	32	-	M200x3	M6	8,9	OH3040H	KML40	MBL40
	200	240	120	32	-	M200x3	M6	8,9	OH3040B	KML40	MBL40	
	200	240	120	32	-	M200x3	M6	8,9	OH3040HB	KML40	MBL40	
	200	240	150	32	-	M200x3	-	12	H3140	KM40	MB40	
	200	240	150	32	-	M200x3	M6	12	OH3140H	KM40	MB40	
	200	240	150	32	-	M200x3	M6	12	OH3140B	KM40	MB40	
	200	240	150	32	-	M200x3	M6	12	OH3140HB	KM40	MB40	
	200	240	176	32	-	M200x3	-	13,9	H2340	KM40	MB40	
	200	240	176	32	-	M200x3	M6	13,9	OH2340	KM40	MB40	
	200	240	176	32	-	M200x3	M6	13,9	OH2340H	KM40	MB40	
	200	240	176	32	-	M200x3	M6	13,9	OH2340B	KM40	MB40	
	200	240	176	32	-	M200x3	M6	13,9	OH2340HB	KM40	MB40	
	200	240	176	32	-	M200x3	M6	13,9	OH2340HB	KM40	MB40	
	200	220	260	126	30	41	M220x4	-	9,9	H3044	HML44	MBL44

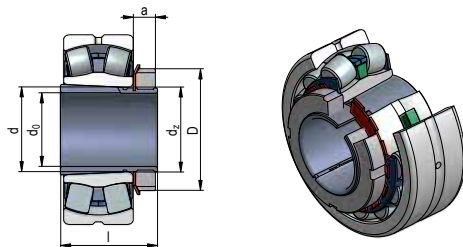

Rozmery mm								Hmotnosť	Označenie púzdra	Príslušné súčasti	
d ₀	d	D	l	a	a ₁	d ₂	d ₂₁	kg	vrátane matice a poistenia	Matica	Podložka
200	220	260	126	30	41	M220x4	M6	9,9	OH3044	HML44	MBL44
	220	260	126	30	41	M220x4	M6	9,9	OH3044H	HML44	MBL44
	220	260	126	30	41	M220x4	M6	9,9	OH3044B	HML44	MBL44
	220	260	126	30	41	M220x4	M6	9,9	OH3044HB	HML44	MBL44
	220	280	161	35	-	M220x4	-	14,3	H3144	HM44	MB44
	220	280	161	35	-	M220x4	M6	14,3	OH3144	HM44	MB44
	220	280	161	35	-	M220x4	M6	14,3	OH3144H	HM44	MB44
	220	280	161	35	-	M220x4	M6	14,3	OH3144B	HM44	MB44
	220	280	161	35	-	M220x4	M6	14,3	OH3144HB	HM44	MB44
	220	280	186	35	-	M220x4	-	17	H2344	HM44	MB44
	220	280	186	35	-	M220x4	M6	17	OH2344	HM44	MB44
	220	280	186	35	-	M220x4	M6	17	OH2344H	HM44	MB44
220	240	290	133	34	46	M240x4	M6	12	OH3048	HML48	MBL48
	240	290	133	34	46	M240x4	M6	12	OH3048B	HML48	MBL48
	240	290	133	34	46	M240x4	M6	12	OH3048H	HML48	MBL48
	240	290	133	34	46	M240x4	M6	12	OH3048B	HML48	MBL48
	240	290	133	34	46	M240x4	M6	12	OH3048HB	HML48	MBL48
	240	300	172	37	-	M240x4	-	15,1	H3148	HM48	MB48
	240	300	172	37	-	M240x4	M6	15,1	OH3148	HM48	MB48
	240	300	172	37	-	M240x4	M6	15,1	OH3148H	HM48	MB48
	240	300	172	37	-	M240x4	M6	15,1	OH3148B	HM48	MB48
	240	300	172	37	-	M240x4	M6	15,1	OH3148HB	HM48	MB48
	240	300	199	37	-	M240x4	-	19	H2348	HM48	MB48
	240	300	199	37	-	M240x4	M6	19	OH2348	HM48	MB48
240	260	310	145	34	46	Tr260x4	-	13,5	H3052	HML52	MBL52
	260	310	145	34	46	Tr260x4	M6	13,5	OH3052	HML52	MBL52
	260	310	145	34	46	Tr260x4	M6	13,5	OH3052B	HML52	MBL52
	260	310	145	34	46	Tr260x4	M6	13,5	OH3052HB	HML52	MBL52
	260	330	190	39	-	Tr260x4	-	22	H3152	HM52	MB52
	260	330	190	39	-	Tr260x4	M6	22	OH3152	HM52	MB52
	260	330	190	39	-	Tr260x4	M6	22	OH3152H	HM52	MB52
	260	330	190	39	-	Tr260x4	M6	22	OH3152B	HM52	MB52
	260	330	190	39	-	Tr260x4	M6	22	OH3152HB	HM52	MB52
	260	330	211	39	-	Tr260x4	-	24,5	H2352	HM52	MB52
	260	330	211	39	-	Tr260x4	M6	24,5	OH2352	HM52	MB52
	260	330	211	39	-	Tr260x4	M6	24,5	OH2352H	HM52	MB52
260	280	330	152	38	50	Tr280x4	-	16	H3056	HML56	MBL56
	280	330	152	38	50	Tr280x4	M6	16	OH3056	HML56	MBL56
	280	330	152	38	50	Tr280x4	M6	16	OH3056B	HML56	MBL56
	280	330	152	38	50	Tr280x4	M6	16	OH3056HB	HML56	MBL56
	280	350	195	41	-	Tr280x4	-	23	H3156	HM56	MB56
	280	350	195	41	-	Tr280x4	M6	23	OH3156	HM56	MB56

UPÍNACIE PÚZDRA

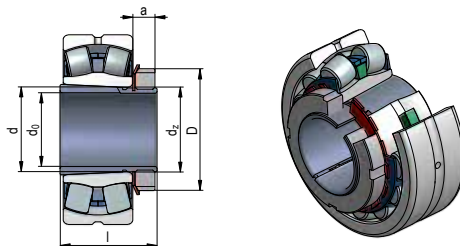

Rozmery mm								Hmotnosť	Označenie púzdra	Príslušné súčasti	
d ₀	d	D	l	a	a ₁	d ₂	d ₂₁	kg	vrátane matice a poistenia	Matica	Podložka
260	280	350	195	41	-	Tr280x4	M6	23	OH3156H	HM56	MB56
	280	350	195	41	-	Tr280x4	M6	23	OH3156B	HM56	MB56
	280	350	195	41	-	Tr280x4	M6	23	OH3156HB	HM56	MB56
	280	350	224	41	-	Tr280x4	-	27	H2356	HM56	MB56
	280	350	224	41	-	Tr280x4	M6	27	OH2356	HM56	MB56
	280	350	224	41	-	Tr280x4	M6	27	OH2356H	HM56	MB56
	280	350	224	41	-	Tr280x4	M6	27	OH2356B	HM56	MB56
	280	350	224	41	-	Tr280x4	M6	27	OH2356HB	HM56	MB56
280	300	360	168	42	54	Tr300x4	-	20,5	H3060	HML60	MSL60
	300	360	168	42	54	Tr300x4	M6	20,5	OH3060	HML60	MSL60
	300	360	168	42	54	Tr300x4	M6	20,5	OH3060H	HML60	MSL60
	300	360	168	42	54	Tr300x4	M6	20,5	OH3060B	HML60	MSL60
	300	360	168	42	54	Tr300x4	M6	20,5	OH3060HB	HML60	MSL60
	300	380	208	40	53	Tr300x4	-	29	H3160	HM60	MS60
	300	380	208	40	53	Tr300x4	M6	29	OH3160	HM60	MS60
	300	380	208	40	53	Tr300x4	M6	29	OH3160H	HM60	MS60
	300	380	208	40	53	Tr300x4	M6	29	OH3160B	HM60	MS60
	300	380	208	40	53	Tr300x4	M6	29	OH3160HB	HM60	MS60
	300	380	240	40	53	Tr300x4	-	32	H3260	HM60	MS60
	300	380	240	40	53	Tr300x4	M6	32	OH3260	HM60	MS60
	300	380	240	40	53	Tr300x4	M6	32	OH3260H	HM60	MS60
	300	380	240	40	53	Tr300x4	M6	32	OH3260B	HM60	MS60
	300	380	240	40	53	Tr300x4	M6	32	OH3260HB	HM60	MS60
	300	320	380	171	42	55	Tr320x5	-	22	H3064	HML64
320		380	171	42	55	Tr320x5	M6	22	OH3064	HML64	MSL64
320		380	171	42	55	Tr320x5	M6	22	OH3064H	HML64	MSL64
320		380	171	42	55	Tr320x5	M6	22	OH3064B	HML64	MSL64
320		380	171	42	55	Tr320x5	M6	22	OH3064HB	HML64	MSL64
320		400	226	42	56	Tr320x5	-	32	H3164	HM64	MS64
320		400	226	42	56	Tr320x5	M6	32	OH3164	HM64	MS64
320		400	226	42	56	Tr320x5	M6	32	OH3164H	HM64	MS64
320		400	226	42	56	Tr320x5	M6	32	OH3164B	HM64	MS64
320		400	226	42	56	Tr320x5	M6	32	OH3164HB	HM64	MS64
320		400	258	42	56	Tr320x5	-	35	H3264	HM64	MS64
320		400	258	42	56	Tr320x5	M6	35	OH3264	HM64	MS64
320		400	258	42	56	Tr320x5	M6	35	OH3264H	HM64	MS64
320		400	258	42	56	Tr320x5	M6	35	OH3264B	HM64	MS64
320		400	258	42	56	Tr320x5	M6	35	OH3264HB	HM64	MS64
320		340	400	187	45	58	Tr340x5	-	27	H3068	HML68
	340	400	187	45	58	Tr340x5	M6	27	OH3068	HML68	MSL68
	340	400	187	45	58	Tr340x5	M6	27	OH3068H	HML68	MSL68
	340	400	187	45	58	Tr340x5	M6	27	OH3068B	HML68	MSL68
	340	400	187	45	58	Tr340x5	M6	27	OH3068HB	HML68	MSL68
	340	440	254	55	72	Tr340x5	-	50	H3168	HM68	MS68
	340	440	254	55	72	Tr340x5	M6	49,5	OH3168	HM68	MS68
	340	440	254	55	72	Tr340x5	M6	49,5	OH3168H	HM68	MS68
	340	440	254	55	72	Tr340x5	M6	49,5	OH3168B	HM68	MS68
	340	440	254	55	72	Tr340x5	M6	49,5	OH3168HB	HM68	MS68
	340	440	288	55	72	Tr340x5	-	51,5	H3268	HM68	MS68
	340	440	288	55	72	Tr340x5	M6	51,5	OH3268	HM68	MS68
340	440	288	55	72	Tr340x5	M6	51,5	OH3268H	HM68	MS68	

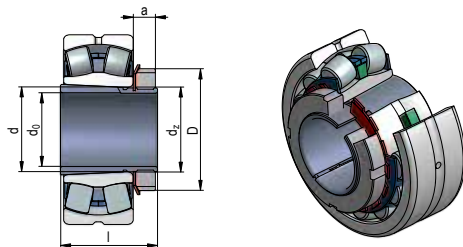

Rozmery mm								Hmotnosť	Označenie púzdra	Príslušné súčasti		
d ₀	d	D	l	a	a ₁	d ₂	d ₂₁	kg	vrátane matice a poistenia	Matica	Podložka	
320	340	440	288	55	72	Tr340x5	M6	51,5	OH3268B	HM68	MS68	
	340	440	288	55	72	Tr340x5	M6	51,5	OH3268HB	HM68	MS68	
340	360	420	188	45	58	Tr360x5	-	29	H3072	HML72	MSL72	
	360	420	188	45	58	Tr360x5	M6	29	OH3072	HML72	MSL72	
	360	420	188	45	58	Tr360x5	M6	29	OH3072H	HML72	MSL72	
	360	420	188	45	58	Tr360x5	M6	29	OH3072B	HML72	MSL72	
	360	420	188	45	58	Tr360x5	M6	29	OH3072HB	HML72	MSL72	
	360	460	259	58	75	Tr360x5	-	56	H3172	HM72	MS72	
	360	460	259	58	75	Tr360x5	M6	56	OH3172	HM72	MS72	
	360	460	259	58	75	Tr360x5	M6	56	OH3172H	HM72	MS72	
	360	460	259	58	75	Tr360x5	M6	56	OH3172B	HM72	MS72	
	360	460	259	58	75	Tr360x5	M6	56	OH3172HB	HM72	MS72	
	360	460	299	58	75	Tr360x5	-	60,5	H3272	HM72	MS72	
	360	460	299	58	75	Tr360x5	M6	60,5	OH3272	HM72	MS72	
	360	460	299	58	75	Tr360x5	M6	60,5	OH3272H	HM72	MS72	
	360	460	299	58	75	Tr360x5	M6	60,5	OH3272B	HM72	MS72	
	360	460	299	58	75	Tr360x5	M6	60,5	OH3272HB	HM72	MS72	
	360	380	450	193	48	62	Tr380x5	-	35,5	H3076	HML76	MSL76
		380	450	193	48	62	Tr380x5	M6	35,5	OH3076	HML76	MSL76
		380	450	193	48	62	Tr380x5	M6	35,5	OH3076H	HML76	MSL76
380		450	193	48	62	Tr380x5	M6	35,5	OH3076B	HML76	MSL76	
380		450	193	48	62	Tr380x5	M6	35,5	OH3076HB	HML76	MSL76	
380		490	264	60	77	Tr380x5	-	61,5	H3176	HM76	MS76	
380		490	264	60	77	Tr380x5	M6	61,5	OH3176	HM76	MS76	
380		490	264	60	77	Tr380x5	M6	61,5	OH3176H	HM76	MS76	
380		490	264	60	77	Tr380x5	M6	61,5	OH3176B	HM76	MS76	
380		490	264	60	77	Tr380x5	M6	61,5	OH3176HB	HM76	MS76	
380		490	310	60	77	Tr380x5	-	69,5	H3276	HM76	MS76	
380		490	310	60	77	Tr380x5	M6	69,5	OH3276	HM76	MS76	
380		490	310	60	77	Tr380x5	M6	69,5	OH3276H	HM76	MS76	
380		490	310	60	77	Tr380x5	M6	69,5	OH3276B	HM76	MS76	
380		490	310	60	77	Tr380x5	M6	69,5	OH3276HB	HM76	MS76	
380		400	470	210	52	66	Tr400x5	-	40	H3080	HML80	MSL80
		400	470	210	52	66	Tr400x5	M6	40	OH3080	HML80	MSL80
		400	470	210	52	66	Tr400x5	M6	40	OH3080H	HML80	MSL80
	400	470	210	52	66	Tr400x5	M6	40	OH3080B	HML80	MSL80	
	400	470	210	52	66	Tr400x5	M6	40	OH3080HB	HML80	MSL80	
	400	520	272	62	82	Tr400x5	-	73	H3180	HM80	MS80	
	400	520	272	62	82	Tr400x5	M6	70,6	OH3180	HM80	MS80	
	400	520	272	62	82	Tr400x5	M6	70,6	OH3180H	HM80	MS80	
	400	520	272	62	82	Tr400x5	M6	70,6	OH3180B	HM80	MS80	
	400	520	272	62	82	Tr400x5	M6	70,6	OH3180HB	HM80	MS80	
400	420	490	212	52	66	Tr420x5	-	47	H3084	HML84	MSL84	
	420	490	212	52	66	Tr420x5	M6	47	OH3084	HML84	MSL84	
	420	490	212	52	66	Tr420x5	M6	47	OH3084H	HML84	MSL84	
	420	490	212	52	66	Tr420x5	M6	47	OH3084B	HML84	MSL84	
	420	490	212	52	66	Tr420x5	M6	47	OH3084HB	HML84	MSL84	
	420	540	304	70	90	Tr420x5	-	80	H3184	HM84	MS84	
	420	540	304	70	90	Tr420x5	M6	80	OH3184	HM84	MS84	
	420	540	304	70	90	Tr420x5	M6	80	OH3184H	HM84	MS84	
	420	540	304	70	90	Tr420x5	M6	80	OH3184B	HM84	MS84	

UPÍNACIE PÚZDRA

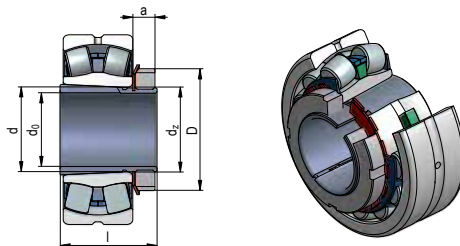

Rozmery mm								Hmotnosť	Označenie púzdra	Príslušné súčasti	
d ₀	d	D	l	a	a ₁	d _z	d _{z1}	kg	vrátane matice a poistenia	Matica	Podložka
400	420	540	304	70	90	Tr420x5	M6	80	OH3184HB	HM84	MS84
	440	520	228	60	77	Tr440x5	-	65	H3088	HML88	MSL88
410	440	520	228	60	77	Tr440x5	M8	65	OH3088	HML88	MSL88
	440	520	228	60	77	Tr440x5	M8	65	OH3088H	HML88	MSL88
	440	520	228	60	77	Tr440x5	M8	65	OH3088B	HML88	MSL88
	440	520	228	60	77	Tr440x5	M8	65	OH3088HB	HML88	MSL88
	440	580	307	70	90	Tr440x5	-	104	H3188	HM88	MS88
	440	580	307	70	90	Tr440x5	M8	104	OH3188	HM88	MS88
	440	580	307	70	90	Tr440x5	M8	104	OH3188H	HM88	MS88
	440	580	307	70	90	Tr440x5	M8	104	OH3188B	HM88	MS88
	440	580	307	70	90	Tr440x5	M8	104	OH3188HB	HM88	MS88
	430	460	540	234	60	77	Tr460x5	-	71	H3092	HML92
460		540	234	60	77	Tr460x5	M8	71	OH3092	HML92	MSL92
460		540	234	60	77	Tr460x5	M8	71	OH3092H	HML92	MSL92
460		540	234	60	77	Tr460x5	M8	71	OH3092B	HML92	MSL92
460		540	234	60	77	Tr460x5	M8	71	OH3092HB	HML92	MSL92
460		580	326	75	95	Tr460x5	-	119	H3192	HM92	MS92
460		580	326	75	95	Tr460x5	M8	119	OH3192	HM92	MS92
460		580	326	75	95	Tr460x5	M8	119	OH3192H	HM92	MS92
460		580	326	75	95	Tr460x5	M8	119	OH3192B	HM92	MS92
460		580	326	75	95	Tr460x5	M8	119	OH3192HB	HM92	MS92
450	480	560	237	60	77	Tr480x5	-	75	H3096	HML96	MSL96
	480	560	237	60	77	Tr480x5	M8	75	OH3096	HML96	MSL96
	480	560	237	60	77	Tr480x5	M8	75	OH3096H	HML96	MSL96
	480	560	237	60	77	Tr480x5	M8	75	OH3096B	HML96	MSL96
	480	560	237	60	77	Tr480x5	M8	75	OH3096HB	HML96	MSL96
	480	620	335	75	95	Tr480x5	-	135	H3196	HM96	MS96
	480	620	335	75	95	Tr480x5	M8	135	OH3196	HM96	MS96
	480	620	335	75	95	Tr480x5	M8	135	OH3196H	HM96	MS96
	480	620	335	75	95	Tr480x5	M8	135	OH3196B	HM96	MS96
	480	620	335	75	95	Tr480x5	M8	135	OH3196HB	HM96	MS96
470	500	580	247	68	85	Tr500x5	-	82	H30/500	HML/500	MSL/500
	500	580	247	68	85	Tr500x5	M8	81,8	OH30/500	HML/500	MSL/500
	500	580	247	68	85	Tr500x5	M8	81,8	OH30/500H	HML/500	MSL/500
	500	580	247	68	85	Tr500x5	M8	81,8	OH30/500B	HML/500	MSL/500
	500	580	247	68	85	Tr500x5	M8	81,8	OH30/500HB	HML/500	MSL/500
	500	630	356	80	100	Tr500x5	-	147	H31/500	HM/500	MS/500
	500	630	356	80	100	Tr500x5	M8	146,4	OH31/500	HM/500	MS/500
	500	630	356	80	100	Tr500x5	M8	146,4	OH31/500H	HM/500	MS/500
	500	630	356	80	100	Tr500x5	M8	146,4	OH31/500B	HM/500	MS/500
	500	630	356	80	100	Tr500x5	M8	146,4	OH31/500HB	HM/500	MS/500
500	530	630	265	68	90	Tr530x6	-	105	H30/530	HML/530	MSL/530
	530	630	265	68	90	Tr530x6	M8	105	OH30/530	HML/530	MSL/530
	530	630	265	68	90	Tr530x6	M8	105	OH30/530H	HML/530	MSL/530
	530	630	265	68	90	Tr530x6	M8	105	OH30/530B	HML/530	MSL/530
	530	630	265	68	90	Tr530x6	M8	105	OH30/530HB	HML/530	MSL/530

Poznámka:
d_{z1} - veľkosť závitů na pripojenie hydraulického hadice
a₁ - šírka km matice vrátane poistovacej skrutky

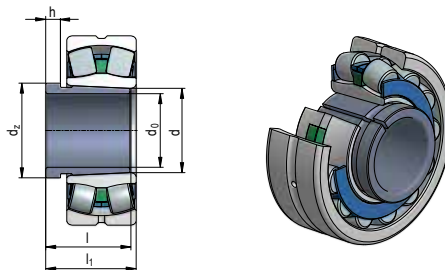

Rozmery mm							Hmotnosť kg	Označenie púzdra	Doplnkové príslušenstvo
d ₀	d	l	l ₁	d ₂	h	d ₂₁			Matica
35	40	25	27	M45x1,5	6	-	0,080	AH208	KM9
	40	29	32	M45x1,5	6	-	0,090	AH308	KM9
	40	40	43	M45x1,5	7	-	0,130	AH2308	KM9
40	45	26	29	M50x1,5	6	-	0,100	AH209	KM10
	45	31	34	M50x1,5	6	-	0,120	AH309	KM10
	45	44	47	M50x1,5	7	-	0,160	AH2309	KM10
45	50	28	31	M55x2	7	-	0,120	AH210	KM11
	50	35	38	M55x2	7	-	0,130	AH310	KM11
	50	50	53	M55x2	9	-	0,190	AH2310	KM11
50	55	29	32	M60x2	7	-	0,160	AH211	KM12
	55	37	40	M60x2	7	-	0,170	AH311	KM12
	55	54	57	M60x2	9	-	0,260	AH2311	KM12
55	60	32	35	M65x2	8	-	0,170	AH212	KM13
	60	40	43	M65x2	8	-	0,190	AH312	KM13
	60	58	61	M65x2	11	-	0,300	AH2312	KM13
60	65	32,5	36	M70x2	8	-	0,190	AHX213	KM14
	65	42	45	M70x2	8	-	0,220	AH313	KM14
	65	61	64	M70x2	12	-	0,360	AHX2313	KM14
65	70	33,5	37	M75x2	8	-	0,200	AHX214	KM15
	70	43	47	M75x2	8	-	0,240	AH314	KM15
	70	64	68	M75x2	12	-	0,420	AHX2314	KM15
70	75	34,5	38	M80x2	8	-	0,250	AHX215	KM16
	75	45	49	M80x2	8	-	0,326	AH315	KM16
	75	68	72	M80x2	12	-	0,480	AHX2315	KM16
75	80	35,5	39	M90x2	8	-	0,300	AH216	KM18
	80	48	52	M90x2	8	-	0,370	AH316	KM18
	80	71	75	M90x2	12	-	0,570	AH2316	KM18
80	85	38,5	42	M95x2	9	-	0,370	AH217	KM19
	85	52	56	M95x2	9	-	0,430	AH317	KM19
	85	74	78	M95x2	13	-	0,650	AHX2317	KM19
85	90	40	44	M100x2	9	-	0,430	AH218	KM20
	90	53	57	M100x2	9	-	0,460	AH318	KM20
	90	79	83	M100x2	14	-	0,760	AH2318	KM20
90	90	63	67	M100x2	10	-	0,570	AH3218	KM20
	95	43	47	M105x2	10	-	0,490	AH219	KM21
	95	57	61	M105x2	10	-	0,540	AH319	KM21
95	95	85	89	M105x2	16	-	0,900	AH2319	KM21
	100	45	49	M110x2	10	-	0,530	AH220	KM22
	100	59	63	M110x2	10	-	0,580	AH320	KM22
	100	90	94	M110x2	16	-	1,000	AH2320	KM22

ŠŤAHOVACIE PÚZDRA

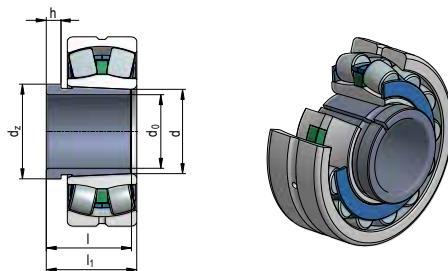

Rozmery mm							Hmotnosť kg	Označenie púzdra	Doplnkové príslušenstvo
d ₀	d	l	l ₁	d ₂	h	d ₂₁			Matica
95	100	64	68	M110x2	11	-	0,660	AH3120	KM22
	100	73	77	M110x2	11	-	0,760	AHX3220	KM22
105	110	50	54	M120x2	12	-	0,630	AH222	KM24
	110	63	67	M120x2	12	-	0,770	AH322	KM24
	110	68	72	M120x2	11	-	0,760	AH3122	KM24
	110	82	86	M120x2	11	-	1,000	AHX3222	KM24
115	120	53	57	M130x2	12	-	0,700	AH224	KM26
	120	60	64	M130x2	13	-	0,730	AH3024	KM26
	120	75	79	M130x2	12	-	0,940	AH3124	KM26
	120	90	94	M130x2	13	-	1,300	AHX3224	KM26
	120	105	109	M130x2	17	-	1,550	AHX2324	KM26
	120	73	82	M125x2	13	-	0,700	AH24024	KM25
125	120	93	102	M130x2	13	-	1,000	AH24124	KM26
	130	53	57	M140x2	12	-	0,820	AH226	KM28
	130	74	78	M140x2	14	-	1,030	AH326	KM28
	130	115	119	M140x2	19	-	2,000	AHX2326	KM28
	130	67	71	M140x2	14	-	0,910	AH3026	KM28
	130	78	82	M140x2	12	-	1,100	AH3126	KM28
	130	98	102	M140x2	15	-	1,550	AHX3226	KM20
	130	83	93	M135x2	14	-	0,880	AH24026	KM27
135	130	94	104	M140x2	14	-	1,150	AH24126	KM28
	140	56	61	M150x2	13	-	1,000	AH228	KM30
	140	77	82	M150x2	14	-	1,150	AH328	KM30
	140	125	130	M150x2	20	-	2,350	AHX2328	KM30
	140	68	73	M150x2	14	-	1,000	AHX3028	KM30
	140	83	88	M150x2	14	-	1,300	AH3128	KM30
	140	104	109	M150x2	15	-	1,850	AHX3228	KM30
	140	83	93	M145x2	14	-	0,950	AH24028	KM29
145	140	99	109	M150x2	14	-	1,300	AH24128	KM30
	150	72	77	M160x3	15	-	1,150	AH3030	KM32
	150	96	101	M160x3	15	-	1,700	AHX3130	KM32
	150	114	119	M160x3	17	-	2,100	AHX3230	KM32
	150	135	140	M160x3	24	-	2,750	AHX2330	KM32
	150	90	101	M155x3	15	-	1,050	AH24030	KM31
150	150	115	126	M160x3	15	-	1,550	AH24130	KM32
	160	77	82	M170x3	16	-	2,000	AH3032	KM34
	160	103	108	M170x3	16	-	3,180	AHX3132	KM34
	160	124	130	M170x3	20	-	3,700	AHX3232	KM34
	160	140	146	M170x3	24	-	4,350	AHX2332	KM34
160	95	106	M170x3	15	-	2,300	AH24032	KM34	

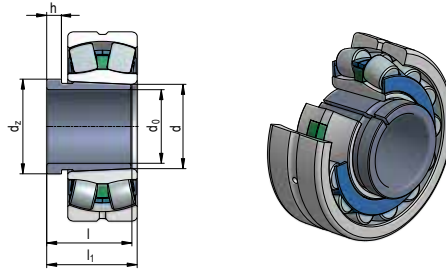

Rozmery mm							Hmotnosť kg	Označenie púzdra	Doplnkové príslušenstvo
d ₀	d	l	l ₁	d ₂	h	d ₂₁			Matica
150	160	124	135	M170x3	15	-	3,000	AH24132	KM34
160	170	69	74	M180x3	16	-	2,210	AH234	KM36
	170	93	98	M180x3	17	-	3,190	AHX334	KM36
	170	146	152	M180x3	24	-	4,850	AHX2334	KM36
	170	85	90	M180x3	17	-	2,450	AH3034	KM36
	170	104	109	M180x3	16	-	3,200	AHX3134	KM36
	170	134	140	M180x3	24	-	4,350	AHX3234	KM36
	170	106	117	M180x3	16	-	2,700	AH24034	KM36
170	180	69	74	M190x3	16	-	2,340	AH236	KM38
	180	105	110	M190x3	17	-	3,750	AHX2236	KM38
	180	154	160	M190x3	26	-	5,500	AHX2336	KM38
	180	92	98	M190x3	17	-	2,800	AH3036	KM38
	180	116	122	M190x3	19	-	3,900	AHX3136	KM38
	180	140	146	M190x3	24	-	4,850	AHX3236	KM38
	180	116	127	M190x3	16	-	3,200	AH24036	KM38
180	190	96	102	M200x4	18	-	3,300	AHX3038	KM40
	190	112	117	M200x4	18	-	3,900	AHX2238	KM40
	190	125	131	M200x3	20	-	4,500	AHX3138	KM40
	190	145	152	M200x3	25	-	5,400	AHX3238	KM40
	190	160	167	M200x3	26	-	6,100	AHX2338	KM40
	190	118	131	M200x3	18	-	3,550	AH24038	KM40
	190	146	159	M200x3	18	-	4,450	AH24138	KM40
190	200	102	108	Tr210x4	19	-	3,700	AHX3040	HM42
	200	134	140	Tr220x4	21	-	5,650	AH3140	HM44
	200	153	160	Tr220x4	25	-	6,600	AH3240	HM44
	200	170	177	Tr220x4	30	-	7,600	AH2340	HM44
	200	127	140	Tr210x4	18	-	4,000	AH24040	HM42
200	200	158	171	Tr210x4	18	-	5,050	AH24140	HM42
	220	111	117	Tr230x4	20	-	7,400	AHX3044	HM46
	220	111	117	Tr230x4	20	G1/8	7,300	AOH3044	HM46
	220	145	151	Tr240x4	23	-	9,300	AH3144	HM48
	220	145	151	Tr240x4	23	G1/4	9,300	AOH3144	HM48
	220	181	189	Tr240x4	30	-	13,500	AH2344	HM48
	220	181	189	Tr240x4	30	G1/4	13,500	AOH2344	HM48
	220	138	152	Tr230x4	20	-	7,450	AH24044	HM46
	220	138	152	Tr230x4	20	G1/8	7,450	AOH24044	HML46
	220	170	184	Tr230x4	20	-	10,000	AH24144	HM46
220	170	184	Tr230x4	20	G1/8	10,000	AOH24144	HML46	

ŠŤAHOVACIE PÚZDRA

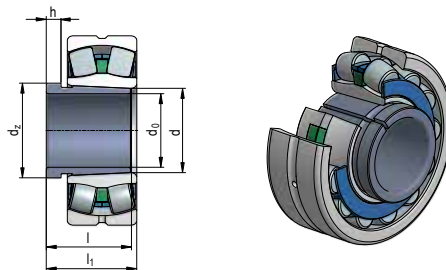

Rozmery mm							Hmotnosť kg	Označenie púzdra	Doplnkové príslušenstvo
d ₀	d	l	l ₁	d ₂	h	d ₂₁			Matica
220	240	116	123	Tr260x4	21	-	7,950	AH3048	HML52
	240	116	123	Tr260x4	21	G1/4	7,950	AOH3048	HM52
	240	154	161	Tr260x4	25	-	12,000	AH3148	HM52
	240	154	161	Tr260x4	25	G1/4	12,000	AOH3148	HM52
	240	189	197	Tr260x4	30	-	14,000	AH2348	HM52
	240	189	197	Tr260x4	30	G1/4	14,000	AOH2348	HM52
	240	138	153	Tr250X4	20	-	8,050	AH24048	HM50
	240	138	153	Tr250X4	20	G1/8	8,050	AOH24048	HM50
	240	180	195	Tr260x4	20	-	11,500	AH24148	HM52
240	260	128	135	Tr280x4	23	-	9,600	AH3052	HML56
	260	128	135	Tr280x4	23	G1/4	9,600	AOH3052	HML56
	260	155	161	Tr280x4	23	-	12,500	AHX2252	HM56
	260	155	161	Tr280x4	23	G1/4	12,500	AOH2252	HM56
	260	172	179	Tr280x4	26	-	16,000	AHX3152	HM56
	260	172	179	Tr280x4	26	G1/4	16,000	AOH3152	HM56
	260	205	213	Tr280x4	30	-	17,500	AHX2352	HM56
	260	205	213	Tr280x4	30	G1/4	17,500	AOH2352	HM56
	260	162	178	Tr280x4	22	-	10,500	AH24052	HM56
	260	202	218	Tr280x4	22	-	14,000	AH24152	HM56
260	280	131	139	Tr300x4	24	-	11,000	AH3056	HML60
	280	131	139	Tr300x4	24	G1/4	11,000	AOH3056	HML60
	280	155	163	Tr300x4	24	-	15,000	AHX2256	HM60
	280	155	163	Tr300x4	24	G1/4	15,000	AOH2256	HM60
	280	175	183	Tr300x4	28	-	17,000	AH3156	HM60
	280	175	183	Tr300x4	28	G1/4	17,000	AOH3156	HM60
	280	212	220	Tr300x4	30	-	21,500	AHX2356	HM60
	280	212	220	Tr300x4	30	G1/4	21,500	AOH2356	HM60
	280	162	179	Tr300x4	22	-	13,500	AH24056	HM60
	280	162	179	Tr300x4	22	G1/8	13,500	AOH24056	HM60
	280	202	219	Tr300x4	22	-	15,000	AH24156	HM60
280	300	145	153	Tr320x5	26	-	13,000	AH3060	HML64
	300	145	153	Tr320x5	26	G1/4	13,000	AOH3060	HML64
	300	170	178	Tr320x5	26	-	18,000	AHX2260	HM64
	300	170	178	Tr320x5	26	G1/4	18,000	AOH2260	HM64
	300	192	200	Tr320x5	30	-	19,000	AHX3160	HM64
	300	192	200	Tr320x5	30	G1/4	19,000	AOH3160	HM64
	300	228	236	Tr320x5	34	-	23,500	AHX3260	HM64

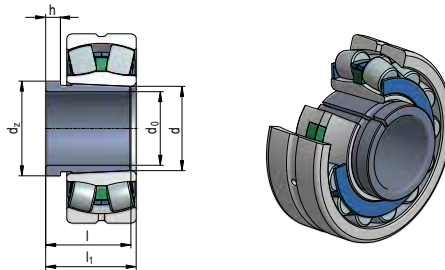

Rozmery mm							Hmotnosť kg	Označenie púzdra	Doplnkové príslušenstvo
d ₀	d	l	l ₁	d ₂	h	d _{z1}			Matica
280	300	228	236	Tr320x5	34	G1/4	23,500	AOH3260	HM64
	300	184	202	Tr320x5	24	-	14,000	AH24060	HM64
	300	184	202	Tr320x5	24	G1/4	14,000	AOH24060	HM64
	300	224	242	Tr320x5	24	-	18,500	AH24160	HM64
	300	224	242	Tr320x5	24	G1/4	18,500	AOH24160	HM64
300	320	149	157	Tr340x5	27	-	16,500	AHX3064	HML68
	320	149	157	Tr340x5	27	G1/4	16,500	AOH3064	HML68
	320	180	190	Tr340x5	27	-	20,000	AHX2264	HM68
	320	180	190	Tr340x5	27	G1/4	20,000	AOH2264	HM68
	320	209	217	Tr340x5	31	-	24,500	AHX3164	HM68
	320	209	217	Tr340x5	31	G1/4	24,500	AOH3164	HM68
	320	246	254	Tr340x5	36	-	27,500	AHX3264	HM68
	320	246	254	Tr340x5	36	G1/4	27,500	AOH3264	HM68
	320	184	202	Tr340x5	24	-	18,000	AH24064	HM68
	320	184	202	Tr340x5	24	G1/4	18,000	AOH24064	HM68
	320	242	260	Tr340x5	24	-	20,500	AH24164	HM68
	320	242	260	Tr340x5	24	G1/4	20,500	AOH24164	HM68
	320	340	162	171	Tr360x5	28	-	17,500	AHX3068
340		162	171	Tr360x5	28	G1/4	17,500	AOH3068	HML72
340		225	234	Tr360x5	33	-	26,500	AHX3168	HM72
340		225	234	Tr360x5	33	G1/4	26,500	AOH3168	HM72
340		264	273	Tr360x5	38	-	32,000	AHX3268	HM72
340		264	273	Tr360x5	38	G1/4	32,000	AOH3268	HM72
340		206	225	Tr360x5	26	-	18,000	AH24068	HM72
340		206	225	Tr360x5	26	G1/4	18,000	AOH24068	HM72
340		269	288	Tr360x5	26	-	25,500	AH24168	HM72
340	360	167	176	Tr380x5	30	-	19,000	AHX3072	HML76
	360	167	176	Tr380x5	30	G1/4	19,000	AOH3072	HML76
	360	229	238	Tr380x5	35	-	30,000	AHX3172	HM76
	360	229	238	Tr380x5	35	G1/4	30,000	AOH3172	HM76
	360	274	283	Tr380x5	40	-	33,000	AHX3272	HM76
	360	274	283	Tr380x5	40	G1/4	33,000	AOH3272	HM76
	360	206	226	Tr380x5	26	-	20,000	AH24072	HM76
	360	206	226	Tr380x5	26	G1/4	20,000	AOH24072	HM76
	360	269	289	Tr380x5	26	-	26,000	AH24172	HM76
360	380	170	180	Tr400x5	31	-	22,500	AHX3076	HML80
	380	170	180	Tr400x5	31	G1/4	22,500	AOH3076	HML80
	380	232	242	Tr400x5	36	-	33,000	AHX3176	HM80
	380	232	242	Tr400x5	36	G1/4	33,000	AOH3176	HM80

ŠŤAHOVACIE PÚZDRA

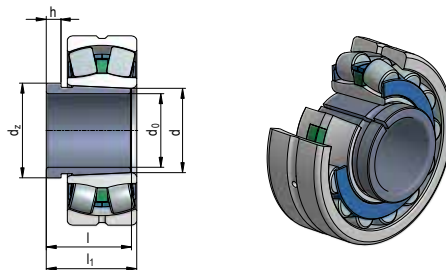

Rozmery mm							Hmotnosť kg	Označenie púzdra	Doplnkové príslušenstvo
d ₀	d	l	l ₁	d ₂	h	d ₂₁			Matica
360	380	232	242	Tr400x5	36	G1/4	33,000	AOH3176	HM80
	380	284	294	Tr400x5	42	-	42,000	AHX3276	HM80
	380	284	294	Tr400x5	42	G1/4	42,000	AOH3276	HM80
	380	208	228	Tr400x5	28	-	23,500	AH24076	HM80
	380	208	228	Tr400x5	28	G1/4	23,500	AOH24076	HM80
	380	271	291	Tr400x5	28	-	31,000	AH24176	HM80
380	400	183	193	Tr420x5	33	-	27,000	AHX3080	HML84
	400	183	193	Tr420x5	33	G1/4	27,000	AOH3080	HML84
	400	240	250	Tr420x5	38	-	39,400	AHX3180	HM84
	400	240	250	Tr420x5	38	G1/4	36,000	AOH3180	HM84
	400	302	312	Tr420x5	44	-	51,500	AHX3280	HM84
	400	303	312	Tr420x5	44	G1/4	51,900	AOH3280	HM84
	400	228	248	Tr420x5	28	-	27,000	AH24080	HM84
	400	228	248	Tr420x5	28	G1/4	27,000	AOH24080	HM84
	400	278	298	Tr420x5	28	-	35,000	AH24180	HM84
	400	278	298	Tr420x5	28	G1/4	35,000	AOH24180	HM84
400	420	186	196	Tr440x5	34	-	29,000	AHX3084	HML88
	420	186	196	Tr440x5	34	G1/4	29,000	AOH3084	HML88
	420	266	276	Tr440x5	40	-	46,000	AHX3184	HM88
	420	266	276	Tr440x5	40	G1/4	46,000	AOH3184	HM88
	420	321	331	Tr440x5	46	-	59,000	AHX3284	HM88
	420	321	331	Tr440x5	46	G1/4	59,000	AOH3284	HM88
	420	230	252	Tr440x5	30	-	29,000	AH24084	HM88
	420	230	252	Tr440x5	30	G1/4	29,000	AOH24084	HM88
420	440	194	205	Tr460x5	35	-	31,000	AHX3088	HML92
	440	194	205	Tr460x5	35	G1/4	31,000	AOHX3088	HML92
	440	270	281	Tr460x5	42	-	46,000	AHX3188	HM92
	440	270	281	Tr460x5	42	G1/4	46,000	AOHX3188	HM92
	440	330	341	Tr460x5	48	-	64,500	AHX3288	HM92
	440	330	341	Tr460x5	48	G1/4	64,500	AOHX3288	HM92
	440	242	264	Tr460x5	30	-	32,000	AH24088	HM92
	440	242	264	Tr460x5	30	G1/4	32,000	AOH24088	HM92
	440	310	332	Tr460x5	30	-	45,500	AH24188	HM92
	440	310	332	Tr460x5	30	G1/4	45,500	AOH24188	HM92
440	460	202	213	Tr480x5	37	-	35,000	AHX3092	HML96
	460	202	213	Tr480x5	37	G1/4	35,000	AOHX3092	HML96
	460	285	296	Tr480x5	43	-	58,000	AHX3192	HM96

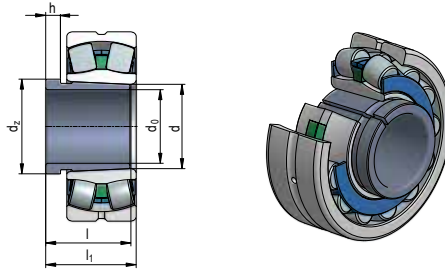

Rozmery mm							Hmotnosť kg	Označenie púzdra	Doplnkové príslušenstvo	
d ₀	d	l	l ₁	d ₂	h	d ₂₁			Matica	
440	460	285	296	Tr480x5	43	G1/4	58,200	AOHX3192	HM96	
	460	349	360	Tr480x5	50	-	75,500	AHX3292	HM96	
	460	349	360	Tr480x5	50	G1/4	75,500	AOHX3292	HM96	
	460	250	273	Tr480x5	32	-	34,500	AH24092	HM96	
	460	250	273	Tr480x5	32	G1/4	34,500	AOH24092	HM96	
	460	332	355	Tr480x5	32	-	50,000	AH24192	HM96	
460	480	205	217	Tr500x5	38	-	39,000	AHX3096	HML/500	
	480	205	217	Tr500x5	38	G1/4	39,000	AOHX3096	HML/500	
	480	295	307	Tr500x5	45	-	63,000	AHX3196	HM/500	
	480	295	307	Tr500x5	45	G1/4	63,000	AOHX3196	HM/500	
	480	364	376	Tr500x5	52	-	82,500	AHX3296	HM/500	
	480	364	376	Tr500x5	52	G1/4	82,500	AOHX3296	HM/500	
	480	250	273	Tr500x5	32	-	36,500	AH24096	HM/500	
	480	250	273	Tr500x5	32	G1/4	36,500	AOH24096	HM/500	
	480	340	363	Tr500x5	32	-	51,500	AH24196	HM/500	
	480	340	363	Tr500x5	32	G1/4	51,500	AOH24196	HM/500	
	480	500	209	221	Tr530x6	40	-	41,000	AHX30/500	HML/530
		500	209	221	Tr530x6	40	G1/4	41,000	AOHX30/500	HML/530
500		313	325	Tr530x6	47	-	66,500	AHX31/500	HM/530	
500		313	325	Tr530x6	47	G1/4	66,500	AOHX31/500	HM/530	
500		393	405	Tr530x6	54	-	89,500	AHX32/500	HM/530	
500		393	405	Tr530x6	54	G1/4	89,500	AOHX32/500	HM/530	
500		253	276	Tr530x6	35	-	43,000	AH240/500	HM/530	
500		253	276	Tr530x6	35	G1/4	43,000	AOH240/500	HM/530	
500		360	383	Tr530x6	35	-	63,000	AH241/500	HM/530	
500		360	383	Tr530x6	35	G1/4	63,000	AOH241/500	HM/530	
500	530	230	242	Tr560x6	45	-	63,500	AH30/530	HML/560	
	530	230	242	Tr560x6	45	G1/4	63,500	AOH30/530	HML/560	
	530	325	337	Tr560x6	53	-	93,500	AH31/530	HM/560	
	530	325	337	Tr560x6	53	G1/4	93,500	AOH31/530	HM/560	
	530	412	424	Tr560x6	57	-	142,000	AH32/530	HM/560	
	530	412	424	Tr560x6	57	G1/4	142,000	AOH32/530	HM/560	
	530	285	309	Tr560x6	35	-	64,500	AH240/530	HM/560	
	530	285	309	Tr560x6	35	G1/4	64,500	AOH240/530	HM/560	
	530	370	394	Tr560x6	35	-	92,000	AH241/530	HM/560	
	530	370	394	Tr560x6	35	G1/4	92,000	AOH241/530	HM/560	

Poznámka:
d₂₁ - veľkosť závitů na pripojenie hydraulickej hadice

KRUHOVÉ MATICE

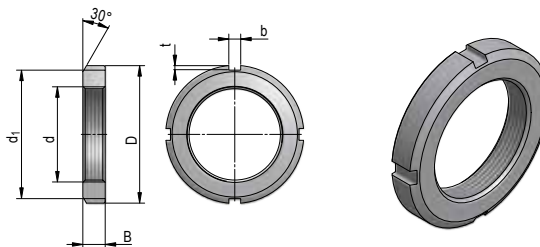

Rozmery mm							Hmotnosť kg	Označenie matice	Príslušné súčasti
d	d ₁	D	B	b	t				podložka
M15x1	21	25	5	4	2	-	0,012	KM2	MB2
M17x1	24	28	5	4	2	-	0,012	KM3	MB3
M20x1	26	32	6	4	2	-	0,02	KM4	MB4
M25x1,5	32	38	7	5	2	-	0,028	KM5	MB5
M30x1,5	38	45	7	5	2	-	0,038	KM6	MB6
M35x1,5	44	52	8	5	2	-	0,058	KM7	MB7
M40x1,5	50	58	9	6	2,5	-	0,078	KM8	MB8
M45x1,5	56	65	10	6	2,5	-	0,11	KM9	MB9
M50x1,5	61	70	11	6	2,5	-	0,14	KM10	MB10
M55x2	67	75	11	7	3	-	0,15	KM11	MB11
M60x2	73	80	11	7	3	-	0,16	KM12	MB12
M65x2	79	85	12	7	3	-	0,19	KM13	MB13
M70x2	85	92	12	8	3,5	-	0,22	KM14	MB14
M75x2	90	98	13	8	3,5	-	0,27	KM15	MB15
M80x2	95	105	15	8	3,5	-	0,397	KM16	MB16
M85x2	102	110	16	8	3,5	-	0,42	KM17	MB17
M90x2	108	120	16	10	4	-	0,51	KM18	MB18
M95x2	113	125	17	10	4	-	0,58	KM19	MB19
M100x2	120	130	18	10	4	-	0,68	KM20	MB20
M105x2	126	140	18	12	5	-	0,81	KM21	MB21
M110x2	133	145	19	12	5	-	0,89	KM22	MB22
M115x2	137	150	19	12	5	-	0,91	KM23	MB23
M120x2	135	145	20	12	5	-	0,69	KML24	MBL24
	138	155	20	12	5	-	0,98	KM24	MB24
M125x2	148	160	21	12	5	-	1,1	KM25	MB25
M130x2	145	155	21	12	5	-	0,84	KML26	MBL26
	149	165	21	12	5	-	1,2	KM26	MB26
M135x2	160	175	22	14	6	-	1,4	KM27	MB27
M140x2	155	165	22	12	5	-	0,92	KML28	MBL28
	160	180	22	14	6	-	1,4	KM28	MB28
M145x2	171	190	24	14	6	-	1,85	KM29	MB29
M150x2	170	180	24	14	5	-	1,3	KML30	MBL30
	171	195	24	14	6	-	1,85	KM30	MB30
M155x3	182	200	25	16	7	-	2,05	KM31	MB31
M160x3	180	190	25	14	5	-	1,4	KML32	MBL32
	182	210	25	16	7	-	2,25	KM32	MB32
M165x3	193	210	26	16	7	-	2,3	KM33	MB33
M170x3	190	200	26	16	5	-	1,6	KML34	MBL34
	193	220	26	16	7	-	2,3	KM34	MB34

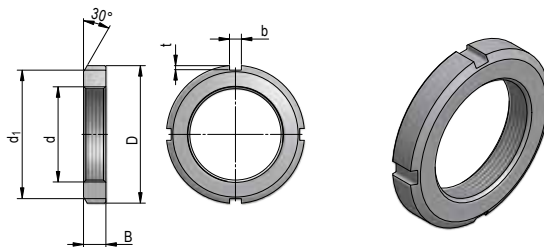

Rozmery mm							Hmotnosť kg	Označenie matice	Príslušné súčasti
d	d ₁	D	B	b	t				podložka
M180x3	200	210	27	16	5	-	1,8	KML36	MBL36
	203	230	27	18	8	-	2,7	KM36	MB36
M190x3	210	220	28	16	5	-	1,9	KML38	MBL38
	214	240	28	18	8	-	3	KM38	BM38
M200x3	222	240	29	18	8	-	2,6	KML40	MBL40
	226	250	29	18	8	-	3,3	KM40	MB40
Tr205x4	232	250	30	18	8	-	3,2	HML41	MBL41
Tr210x4	238	270	30	20	10	-	5,1	HML42	MSL42
Tr215x4	242	260	30	20	9	-	3,3	HML43	MSL43
Tr220x4	242	260	30	20	9	M6	3,4	HML44	MSL44
Tr240x4	270	290	34	20	10	M8	4,85	HML48	MSL48
Tr260x4	290	310	34	20	10	M8	5,15	HML52	MSL52
Tr280x4	310	330	38	24	10	M8	5,5	HML56	MSL56
Tr300x4	336	360	42	24	12	M8	7,25	HML60	MSL60
	340	380	40	24	12	M10	12	HM60	MS60
Tr 310x4	350	390	42	24	12	-	13	HM62	MS62
Tr320x5	356	390	42	24	12	M8	10,5	HML64	MSL64
	360	400	42	24	12	M10	13,5	HM64	MS64
Tr330x5	380	420	52	28	15	-	20	HM66	MS66
Tr340x5	376	400	45	24	12	M8	13	HML68	MSL68
	400	440	55	28	15	M12	23,2	HM68	MS68
Tr345X5	384	410	45	28	13	-	13	HML69	MSL69
Tr350x5	410	450	55	28	15	-	25	HM70	MS70
Tr360x5	420	460	58	28	15	-	27,5	HM72	MS72
Tr370x5	430	470	58	28	15	-	28	HM74	MS74
Tr385x5	422	450	48	28	14	-	15	HML77	MSL77
Tr400x5	470	520	62	32	18	-	40	HM80	MS80
Tr410x5	452	480	52	32	14	-	19	HML82	MSL82
Tr420x5	490	540	70	32	18	-	47	HM84	MS84
Tr430X5	472	500	52	32	14	-	20	HML86	MSL86
Tr440x5	510	560	70	36	20	-	48,5	HM88	MS88
Tr450X5	490	520	60	32	15	-	24	HML90	MSL90
Tr460x5	510	540	60	32	15	-	28	HML92	MSL92
	530	560	60	36	15	M12	29,5	HML96	MSL96
Tr480x5	560	620	75	36	20	M16	62,5	HM96	MS96
	550	580	60	36	15	-	34	HML98	MSL98
Tr500x5	550	580	68	36	15	M12	35	HML/500	MSL/500
	580	630	80	40	23	M16	64	HM/500	MS/500
Tr510x6	590	650	80	40	23	-	79	HM/510	MS/510

KRUHOVÉ MATICE

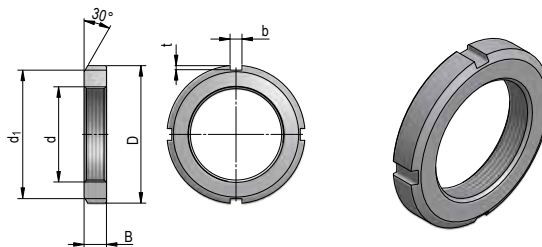

Rozmery mm							Hmotnosť kg	Označenie matice	Príslušné súčasti
d	d ₁	D	B	b	t				podložka
Tr520x6	570	600	68	36	15	-	37	HML/520	MSL/520
Tr530x6	590	630	68	40	20	M16	50	HML/530	MSL/530
	610	670	80	40	23	M20	83	HM/530	MS/530
Tr540x6	590	630	68	40	20	-	47	HML/540	MSL/540
Tr550x6	640	700	80	40	23	-	86	HM/550	MS/550
Tr560x6	610	650	75	40	20	M16	51	HML/560	MSL/560
	650	710	85	45	25	M20	97	HM/560	MS/560

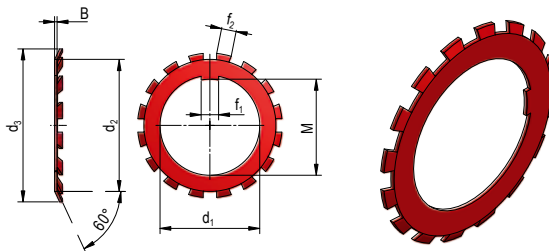

Rozmery mm							Hmotnosť	Označenie
d ₁	d ₂	d ₃	M	B	f ₁	f ₂	100 ks/kg	podložky
10	13,5	21	8,5	1	3	3	0,131	MB0
12	17	25	10,5	1	3	3	0,2	MB1
15	21	28	13,5	1	4	4	0,26	MB2
17	24	32	15,5	1	4	4	0,32	MB3
20	26	36	18,5	1	4	4	0,35	MB4
25	32	42	23	1,25	5	5	0,64	MB5
30	38	49	27,5	1,25	5	5	0,78	MB6
35	44	57	32,5	1,25	6	5	1,05	MB7
40	50	62	37,5	1,25	6	6	1,24	MB8
45	56	69	42,5	1,25	6	6	1,52	MB9
50	61	74	47,5	1,25	6	6	1,6	MB10
55	67	81	52,5	1,5	7	8	1,9	MB11
60	73	86	57,5	1,5	7	8	2,5	MB12
65	79	92	62,5	1,5	7	8	2,9	MB13
70	85	98	66,5	1,5	8	8	3,3	MB14
75	90	104	71,5	1,5	8	8	3,6	MB15
80	95	112	76,5	1,8	10	8	4,6	MB16
85	102	119	81,5	1,8	10	8	5,2	MB17
90	108	126	86,5	1,8	10	10	6,1	MB18
95	113	133	91,5	1,8	10	10	6,7	MB19
100	120	142	96,5	1,8	12	10	7,6	MB20
105	126	145	100,5	1,8	12	12	8,3	MB21
110	133	154	105,5	1,8	12	12	9,4	MB22
115	137	159	110,5	2	12	12	10,3	MB23
120	135	151	115	2	14	12	7	MBL24
125	138	164	115	2	12	14	10,5	MB24
125	148	170	120	2	12	14	11,8	MB25
130	145	161	125	2	12	14	8	MBL26
135	149	175	125	2	12	14	11,8	MB26
135	160	185	130	2	14	14	14,4	MB27
140	155	171	135	2	14	16	9	MBL28
140	160	192	135	2	14	16	15,4	MB28
145	171	202	140	2	14	16	16,8	MB29
150	170	188	145	2	14	16	10	MBL30
150	171	205	145	2	14	16	18,5	MB30
155	182	212	147,5	2,5	16	16	20,9	MB31
160	180	199	154	2,5	16	18	14	MBL32
160	182	217	154	2,5	16	18	22,2	MB32
165	193	222	157,5	2,5	18	18	24,1	MB33
170	190	211	164	2,5	18	16	17	MBL34
170	193	232	164	2,5	18	16	24,7	MB34
180	200	221	174	2,5	20	18	18	MBL36
180	203	242	174	2,5	20	18	25,8	MB36
190	210	231	184	2,5	20	18	20,5	MBL38
190	214	252	184	2,5	20	18	27,8	MB38
200	222	248	194	2,5	20	18	21,4	MBL40
200	226	262	194	2,5	20	18	29,3	MB40
220	250	292	213	3	22	20	35	MB44
240	270	312	233	3	22	20	45	MB48
260	300	342	253	3	28	24	65	MB52
280	320	362	273	3	28	24	105	MB56

POISTNÉ VLOŽKY

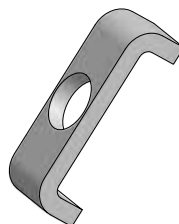
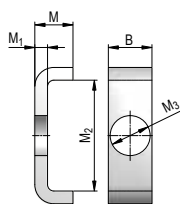

Rozmery mm					Hmotnosť	Označenie	Príslušná skrutka
B	M	M ₁	M ₂	M ₃	kg		
20	12	4	13,5	7	0,022	MSL44	M6X12
	12	4	17,5	9	0,024	MSL48	M8X16
24	12	4	17,5	9	0,03	MSL56	M8X16
	12	4	20,5	9	0,033	MSL60	M8X16
	15	5	21	9	0,046	MSL64	M8X16
28	15	5	20	9	0,051	MSL72	M8X16
	15	5	24	12	0,055	MSL76	M10X20
32	15	5	24	12	0,063	MSL84	M10X20
	15	5	28	14	0,067	MSL88	M12X25
36	15	5	28	14	0,076	MSL96	M12X25
40	21	7	28	18	0,15	MSL/530	M16X30
	21	7	29	18	0,14	MSL/560	M16X30
45	21	7	34	18	0,17	MSL/630	M16X30
	21	7	39	18	0,19	MSL/670	M16X30
50	21	7	39	18	0,21	MSL/710	M16X30
55	21	7	39	18	0,23	MSL/750	M16X30
60	21	7	44	22	0,26	MSL/850	M20X40
	21	7	46	22	0,26	MSL/950	M20X40
	21	7	51	22	0,28	MSL/1000	M20X40
20	12	4	22,5	9	0,02	MS44	M8X16
24	12	4	25,5	12	0,03	MS52	M8X16
	12	4	30,5	12	0,04	MS60	M10X20
	15	5	31	12	0,055	MS64	M10X20
28	15	5	38	14	0,069	MS68	M10X20
32	15	5	40	14	0,083	MS76	M12X25
	15	5	45	18	0,089	MS80	M12X25
36	15	5	43	18	0,097	MS88	M16X30
	15	5	53	18	0,11	MS96	M16X30
40	15	5	45	18	0,11	MS/500	M16X30
	21	7	51	22	0,19	MS/530	M16X30
45	21	7	54	22	0,22	MS/560	M20X40
50	21	7	61	22	0,27	MS/630	M20X40
	21	7	66	22	0,28	MS/670	M20X40
55	21	7	69	26	0,32	MS/710	M20X40
60	21	7	70	26	0,35	MS/750	M24X50
70	21	7	71	26	0,41	MS/850	M24X50
	21	7	76	26	0,41	MS/900	M24X50
	21	7	78	26	0,42	MS/950	M24X50
	21	7	88	26	0,5	MS/1000	M24X50

